

STL UX™ Series

LED Stairwell Strip

Includes: STL-4UX



INSTALLATION INSTRUCTIONS

READ AND FOLLOW ALL SAFETY INSTRUCTIONS

WARNING

FAILURE TO FOLLOW THESE INSTRUCTIONS AND WARNINGS MAY RESULT IN SERIOUS INJURY OR DAMAGE TO PROPERTY

For your safety, thoroughly read these instructions and warnings in its entirety prior to installing or servicing this product. These instructions do not attempt to cover all installation and maintenance circumstances. If you do not understand these instructions or if additional information is needed, please contact Aleo Lighting customer service.

WARNING

RISK OF FIRE OR ELECTRIC SHOCK

This product must be installed and serviced by a professional electrician in accordance with applicable federal, state, and local laws, regulations, and electrical code. If not qualified, do not attempt installation of this product. Contact a qualified electrician.

WARNING

RISK OF FIRE, ELECTRIC SHOCK, or PERSONAL INJURY

To avoid risk of electrical shock, turn off power before installing or servicing.

Verify that supply voltage is correct by comparing with the input voltage on the luminaire label

Make all electrical and ground connections in accordance with NEC and any applicable code requirements

WARNING

RISK OF PERSONAL INJURY

To prevent wiring damage or abrasion, do not expose wiring to edges of sheet metal or other sharp objects
Do not make or alter any open holes in any of the enclosures with wiring or electrical components during installation

SAVE THESE INSTRUCTIONS FOR FUTURE REFERENCE

Suitable for Dry or Damp Location

Do Not use outdoors

WARNING

This luminaire is made for permanent installation in ordinary (non-hazardous) locations in accordance with NEC code and all applicable local and federal codes. Do not use in applications with limited ventilation or high ambient temperature enclosures.

WARNING

RISK OF FIRE, ELECTRIC SHOCK, or PERSONAL INJURY

To avoid risk of electrical shock, AC Power must be off before installing or servicing of emergency driver. Verify that supply voltage is correct by comparing with the input voltage on the driver label Make all electrical and ground connections in accordance with NEC and any applicable code requirements.

TURN OFF POWER BEFORE INSTALLING

Electrical Connection

1. Connect BLACK (line) driver lead to voltage supply Line position (HOT).
2. Connect driver WHITE lead to the NEUTRAL supply position.
3. Connect the GREEN ground lead to the supply ground lead.

If using 0-10V dimming:

4. Connect VIOLET lead to supply POSITIVE dimming lead.
5. Connect GREY lead to the supply NEGATIVE dimming lead.

If NOT using 0-10V dimming:

6. Ensure VIOLET and GREY 0-10V dimming leads are properly capped.

Wiring Diagram

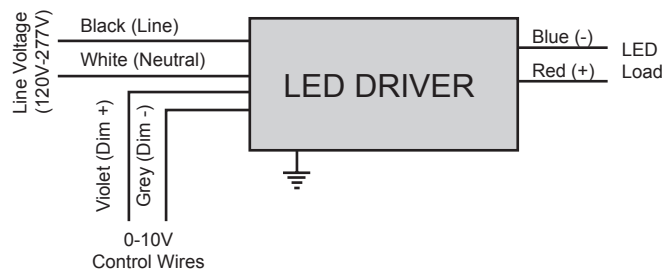

STL UX™ Series LED Stairwell Strip

TO INSTALL:

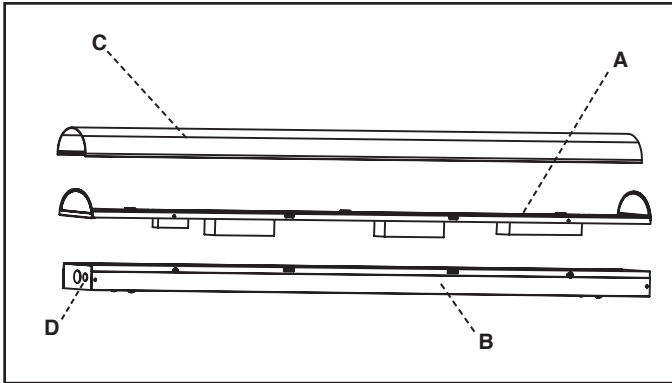

Field-Adjustable CCT

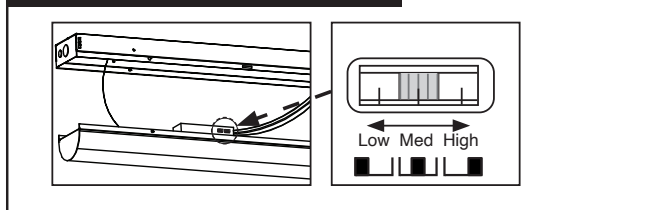

Parts

- A: Gear Tray
- B: Channel Housing
- C: Lens
- D: EM Test Button Knockout

TURN OFF POWER BEFORE INSTALLING

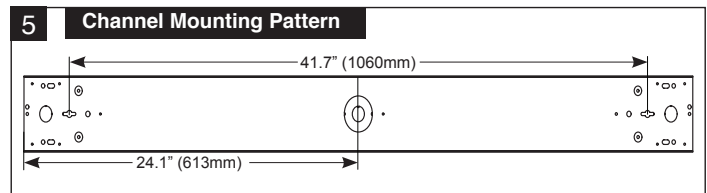
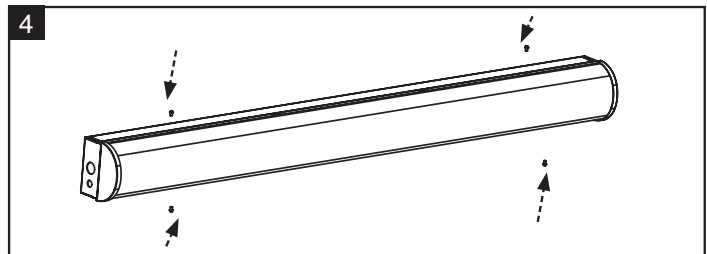
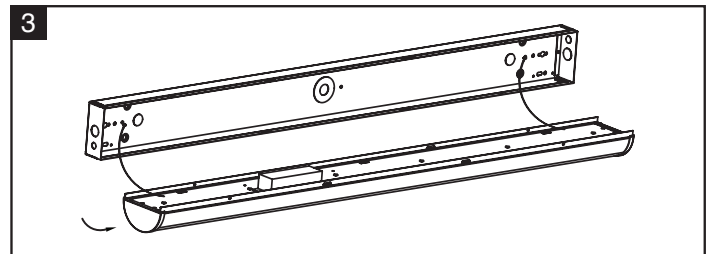
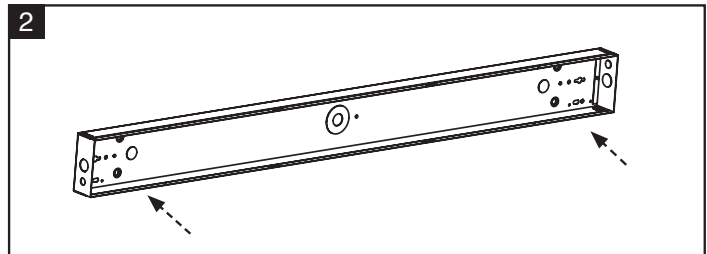
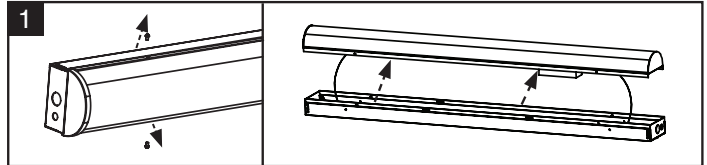

WALL MOUNT (SURFACE) INSTALLATION

1. Remove Gear Tray (A) from fixture Channel Housing (B) by removing (4) screws off the side of the Gear Tray below the lens. **Figure 1**
2. Mount the fixture Channel Housing (B) to a secure structure on the wall with appropriate fasteners and anchors (not supplied). (2 keyholes (**Figure 5**) or other mounting holes are available on the Channel Housing (B) for surface mounting purposes. **Figure 2**
3. Hang Gear Tray (A) to Channel Housing (B) by attaching provided safety lanyards. Ensure lens and Gear Tray are not damaged while hanging. **Figure 3**
4. Thread EM Test Button through desired knockout hole (D) located on the side end cap of the fixture Channel Housing (B).
5. Ensure all sensor wires are connected properly (SEE WIRING DIAGRAM on PG.3). Ensure all leads into sensor terminals are securely connected.
6. Make wiring connections from AC Mains to fixture AC input. SEE PG.3 for Electrical Connection and wiring diagram instructions.
7. Adjust sensor settings via dip switches on sensor if needed (refer to sensor instruction sheet for settings information)
8. Bring Gear Tray (A) to fixture Channel Housing (B) and attach by covering Channel Housing with Gear Tray. Secure (4) screws on the side of the Gear Tray **Figure 4**. Ensure leads do not hang out of Gear Tray to avoid electrical wiring being clamped between metal parts.

aleo™
LED LIGHTING

Aleo Lighting, Inc.
www.aleolighting.com
10988 Bloomfield Ave.
Santa Fe Springs, CA
Ph: 877-358-8825

© 2020 Aleo Lighting, Inc. All rights reserved. For informational purposes only. Reproduction in whole or part is prohibited without prior written consent of the copyright owner. The information presented in this document does not form part of any quotation or contract, is believed to be accurate and reliable and may be changed without notice. No liability will be accepted by the publisher for any consequences of its use.