

LWF™ Series

LED Utility Low Profile Wrap

Includes: LWF-2L, LWF-4L

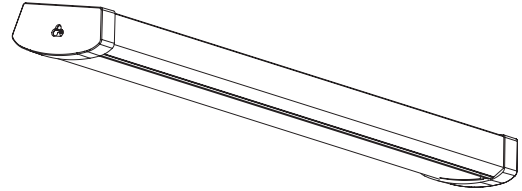

INSTALLATION INSTRUCTIONS

READ AND FOLLOW ALL SAFETY INSTRUCTIONS

WARNING

FAILURE TO FOLLOW THESE INSTRUCTIONS AND WARNINGS MAY RESULT IN SERIOUS INJURY OR DAMAGE TO PROPERTY

For your safety, thoroughly read these instructions and warnings in its entirety prior to installing or servicing this product. These instructions do not attempt to cover all installation and maintenance circumstances. If you do not understand these instructions or if additional information is needed, please contact Aleo Lighting customer service.

WARNING

RISK OF FIRE OR ELECTRIC SHOCK

This product must be installed and serviced by a professional electrician in accordance with applicable federal, state, and local laws, regulations, and electrical code. If not qualified, do not attempt installation of this product. Contact a qualified electrician.

WARNING

RISK OF FIRE, ELECTRIC SHOCK, or PERSONAL INJURY

To avoid risk of electrical shock, turn off power before installing or servicing.

Verify that supply voltage is correct by comparing with the input voltage on the luminaire label

Make all electrical and ground connections in accordance with NEC and any applicable code requirements

WARNING

RISK OF PERSONAL INJURY

To prevent wiring damage or abrasion, do not expose wiring to edges of sheet metal or other sharp objects
Do not make or alter any open holes in any of the enclosures with wiring or electrical components during installation

SAVE THESE INSTRUCTIONS FOR FUTURE REFERENCE

Suitable for Dry or Damp Location

WARNING

This luminaire is made for permanent installation in ordinary (non-hazardous) locations in accordance with NEC code and all applicable local and federal codes. Do not use in applications with limited ventilation or high ambient temperature enclosures.

TURN OFF POWER BEFORE INSTALLING

Electrical Connection

1. Connect BLACK (line) driver lead to voltage supply Line position (HOT).
2. Connect driver WHITE lead to the NEUTRAL supply position.
3. Connect the GREEN ground lead to the supply ground lead.

Wiring Diagram

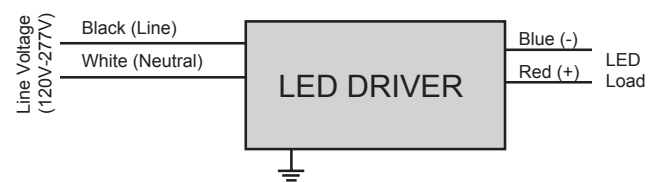

LWF™ Series LED Utility Low Profile Wrap

TO INSTALL:

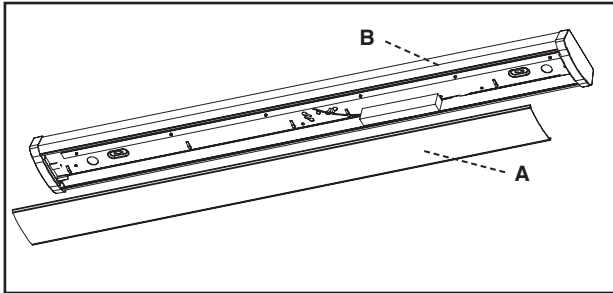

Parts

- A: Lens
- B: Luminaire Housing

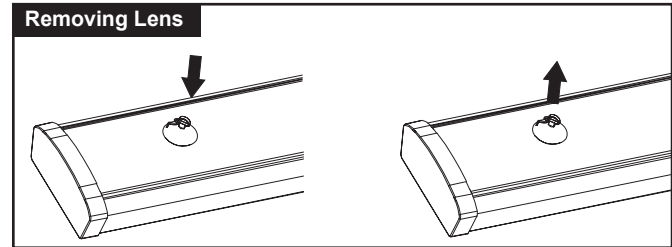

1. Remove lens starting from the housing near one end of the housing by using the provided suction cup. Press the suction cup to absorb one side of the lens. Pull the suction cup to detach the lens from the luminaire housing
2. Determine wiring access point and remove appropriate knockout.
3. Determine installation point and locate studs. Measure location of installation point.

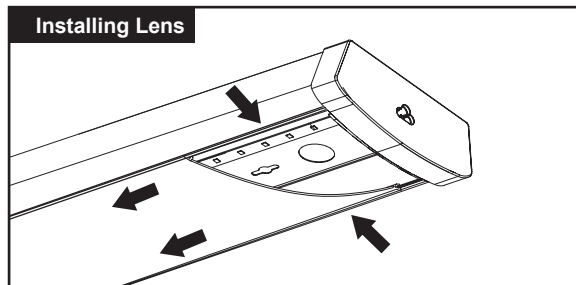
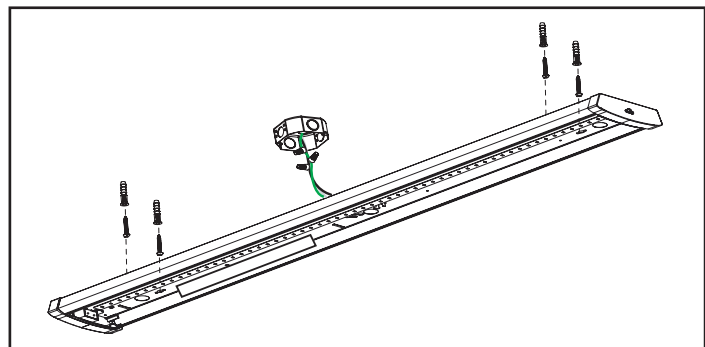

4. Pre-mount 1" mounting fasteners or 3" x 3/16 toggle bolts.
5. For rear access point feed, feed wires through appropriate hole.
6. Secure fixture in place using keyhole slots and pre-mounted fasteners. Tighten fasteners to ensure a secure mount.
7. Make wiring connection. SEE PAGE 1 for Electrical Connection and wiring diagram instructions.

Tandem Linking

1. After removing the connector cover, connect the luminaires by inserting the double-end male connector into the female connectors at the end cap of the luminaire. Ensure a tight connection between fixtures.

LWF End Cap

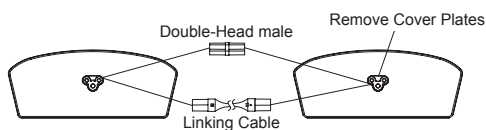

aleo™
LED LIGHTING

Aleo Lighting, Inc.
www.aleolighting.com
13924 Bettencourt St.
Cerritos, CA 90703
(P) 877-358-8825
(P) 562-546-7288

© 2019 Aleo Lighting, Inc. All rights reserved. For informational purposes only. Reproduction in whole or part is prohibited without prior written consent of the copyright owner. The information presented in this document does not form part of any quotation or contract, is believed to be accurate and reliable and may be changed without notice. No liability will be accepted by the publisher for any consequences of its use.