

# LSR™ UX Series

## Linear LED Strip Retrofit Kit

Includes: LSR-4UXL-30/8CT XE G4,  
LSR-8UXH-65/8CT XE G4

**aleo™**  
LED LIGHTING



## INSTALLATION INSTRUCTIONS

READ AND FOLLOW ALL SAFETY INSTRUCTIONS

### WARNING

**FAILURE TO FOLLOW THESE INSTRUCTIONS AND WARNINGS MAY RESULT IN SERIOUS INJURY OR DAMAGE TO PROPERTY**

For your safety, thoroughly read these instructions and warnings in its entirety prior to installing or servicing this product. These instructions do not attempt to cover all installation and maintenance circumstances. If you do not understand these instructions or if additional information is needed, please contact Aleo Lighting customer service.

### WARNING

#### RISK OF FIRE OR ELECTRIC SHOCK

This product must be installed and serviced by a professional electrician in accordance with applicable federal, state, and local laws, regulations, and electrical code. If not qualified, do not attempt installation of this product. Contact a qualified electrician.

Luminaire wiring and electrical parts may be damaged when drilling for installation of LED retrofit kit. Check for enclosed wiring and components. Install this kit only in the luminaires that have the construction features and dimensions shown in the photographs and/or drawings and where the input rating of the retrofit kit does not exceed the input rating of the luminaire.

Only those open holes indicated in the photographs and/or drawings may be made or altered as a result of kit installation. Do not leave any other open holes in an enclosure of wiring or electrical components.

### WARNING

#### RISK OF FIRE, ELECTRIC SHOCK, or PERSONAL INJURY

To avoid risk of electrical shock, turn off power before installing or servicing.

Verify that supply voltage is correct by comparing with the input voltage on the luminaire label.

Make all electrical and ground connections in accordance with NEC and any applicable code requirements.

### WARNING

#### RISK OF PERSONAL INJURY

To prevent wiring damage or abrasion, do not expose wiring to edges of sheet metal or other sharp objects.

Do not make or alter any open holes in any of the enclosures with wiring or electrical components during installation

## SAVE THESE INSTRUCTIONS FOR FUTURE REFERENCE

Suitable for Dry or Damp Location

### WARNING

This luminaire is made for permanent installation in ordinary (non-hazardous) locations in accordance with NEC code and all applicable local and federal codes. Do not use in applications with limited ventilation or high ambient temperature enclosures.

Contents to change without notice. Visit [www.aleolighting.com](http://www.aleolighting.com) for warranty and specification information.

### TO INSTALL:

**TURN OFF POWER BEFORE INSTALLING**

#### Electrical Connection

1. Connect BLACK (line) driver lead to voltage supply Line position (HOT).
2. Connect driver WHITE lead to the NEUTRAL supply position.
3. Connect the GREEN ground lead to the supply ground lead.

**If using 0-10V dimming:**

4. Connect VIOLET lead to supply POSITIVE dimming lead.
5. Connect GREY lead to the supply NEGATIVE dimming lead.

**If NOT using 0-10V dimming:**

6. Ensure VIOLET and GREY 0-10V dimming leads are properly capped.

#### Wiring Diagram

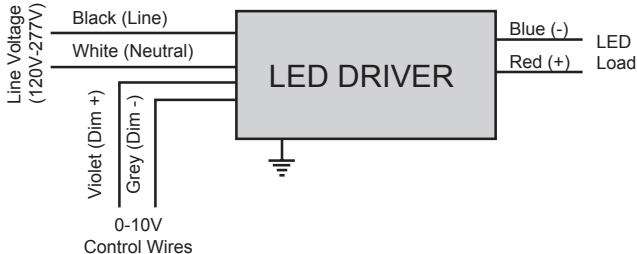

#### Kit Contents

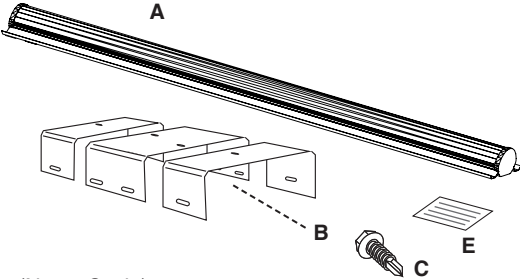

(Not to Scale)

- A:** LED Reflector Gear Tray (LSR4 = x 1) (LSR8 = x 2)
- B:** Strip Bracket
- C:** Tek Screws (multiple)
- D:** Safety Lanyard Kit
- E:** Label
- F:** 1/4-turn Fasteners

#### Tools Required

- Drill
- Pliers
- Cutters
- Gloves
- Screw Driver (optional)



#### Field-Adjustable CCT

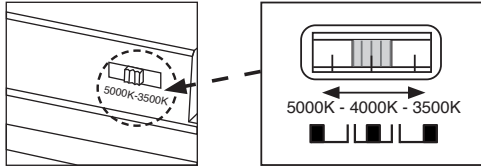

**CAUTION: TURN OFF POWER BEFORE INSTALLING**

**DO NOT TOUCH LED**

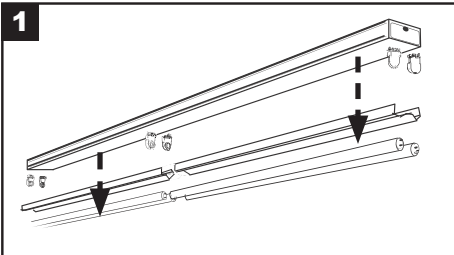

Remove lamps, ballast cover/reflector, socket bracket, and lamp holders from existing host strip luminaire.

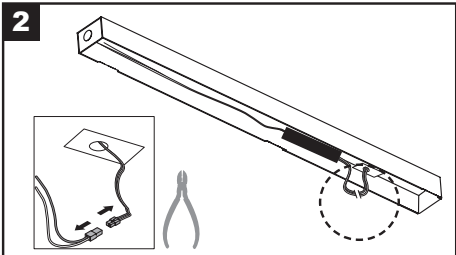

Disconnect AC mains from existing ballast. Depending on size and position of existing ballast, ballast may be removed or left intact.

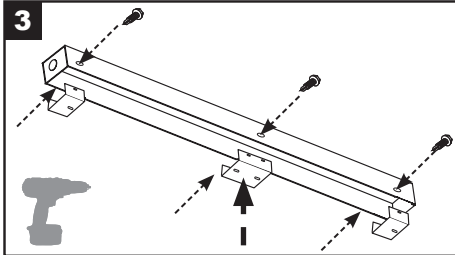

Use Self-tapping Tek Screws (C) to fasten Strip Bracket (B) to existing host strip fixture. For LSR8, make sure to align center piece of Strip Bracket with the center line of the host fixture.

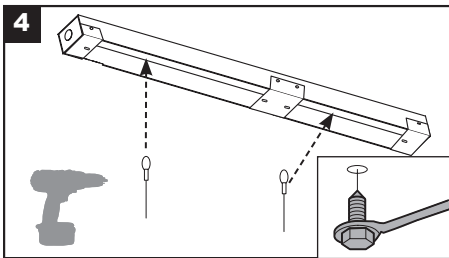

Secure Safety Lanyard cables (D) by fastening self-tapping tek screws (C) to existing strip housing. Make sure to feed tek screws through safety lanyard washers before fastening. Clip opposing end of safety cable to Gear Tray (A).

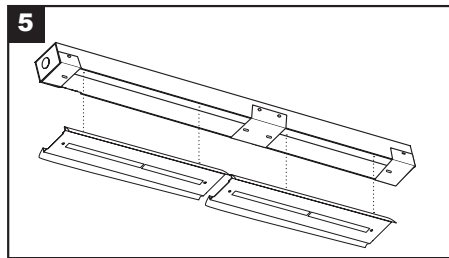

Clip opposing end of safety cable to Gear Tray (A). Use (2) Safety Lanyards for each 4-ft. gear tray section. Hang gear tray with safety cable in order to make electrical wire connection.

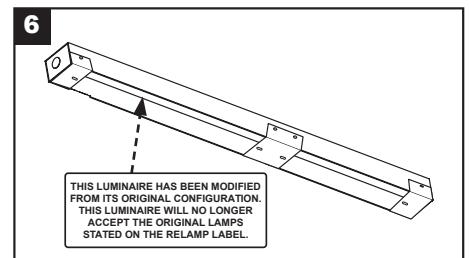

Place Label (E) inside existing host strip housing.



## 7 Ground Connection

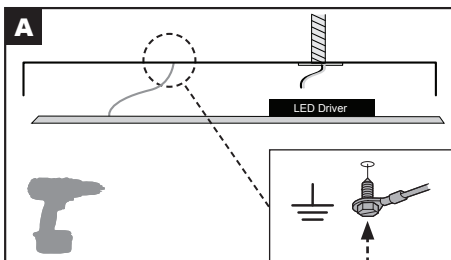

**OPTION A:**  
Securely fasten ground screw lead from Gear Tray (B) to host strip fixture if host strip is grounded.

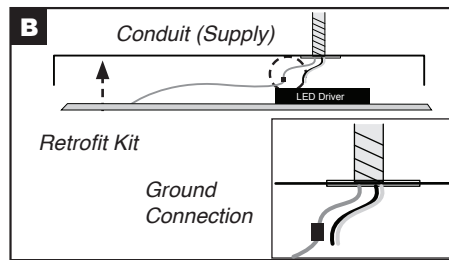

**OPTION B:**  
Connect ground from Gear Tray (B) to supply ground lead from conduit.

## 8 Electrical Connection

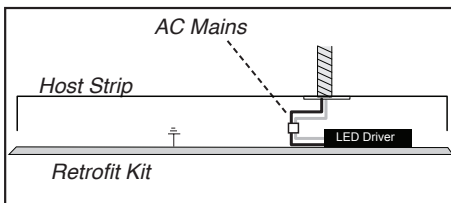

Follow instructions and wiring diagram on Page 1 to connect AC mains to Gear Tray input leads. Retrofit kit comes equipped with quick disconnect. Hide wires behind Gear Tray. Ensure leads do not hang out of Gear Tray to avoid electrical wiring being clamped between metal parts.

## LED Wiring for LSR8

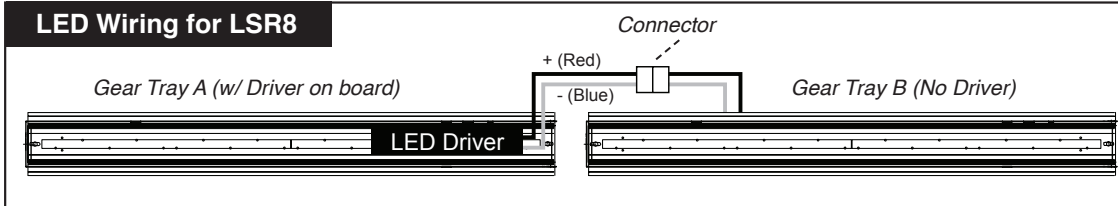

For LSR8 (8-ft. kit), the kit will come with (2) LED Gear Trays (A and B). Gear tray A will have a driver. Connect output leads from Driver located on Gear Tray A to the leads on Gear Tray B by plugging in connector. Ensure leads are connected correctly: Red (+) and Blue (-) from Driver to LED modules.

# LSR™ UX Series

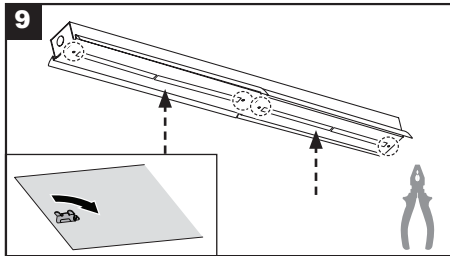

Push Gear Tray towards Strip Brackets so that the Gear Tray sits aflush with the brackets and strip housing. Make sure the slots of the gear tray and brackets are aligned. Fasten Gear Tray by inserting and turning 1/4-turn fasteners (F) 90°.

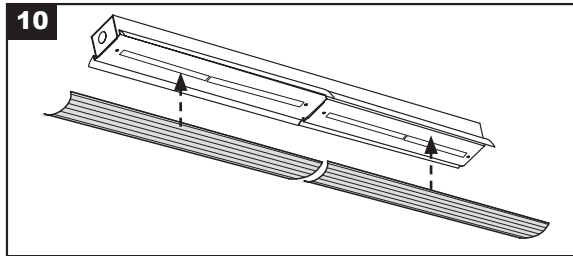

Remove protective packaging from LED modules and lens. Place Lens Diffuser onto retrofit kit by squeezing sides of Lens Diffuser and inserting edges into grooves of Gear Tray. Lens may need to be adjusted by squeezing sides or pressing the face of the lens.